

Wiring Duct

Pro-Duct Wiring Duct

HellermannTyton's Pro-Duct wiring duct efficiently routes and protects wire and cable. Manufactured from high impact, rigid PVC, Pro-Duct includes solid, slotted and high density slotted styles. Available in over 28 sizes, Pro-Duct comes in standard colors of white, gray and black in 6 foot lengths. Blue wiring duct is also available in a variety of standard sizes. Other colors are available. Contact HellermannTyton for minimum volume requirements.

Pro-Duct Features

All styles of Pro-Duct wiring duct (solid, slotted and high density slotted) are designed with many installer preferred features:

- Smooth edges protect installer and wires from abrasion.
- Cover is flush with the side of the duct for increased wire capacity. It also allows for tight, side-by-side placement.
- No cover slippage. The covers are provided with a non-slip plastic lining. This ensures that the covers remain in place during vibration, yet they easily snap on and off, offering ready access to the wire run.
- Mounting holes are designed for installation versatility. Elongated mounting holes allow for changes in panel designs and installation flexibility.
- Mounting holes are standard. Contact HellermannTyton for duct without mounting holes.
- Enhanced wire capacity helps maximize space within panels.
- Interchangeable covers between solid, slotted, and high density slotted styles reduce inventory and increase versatility.
- Professional appearance increases panel's overall neatness.

Pro-Duct is U.L. Recognized, CSA Certified, and carries a U.L. flame rating of 94V0.



Solid Wall Duct

Solid wall duct is designed for straight wire runs where break-outs are not required.

- Smooth edges
- Non-slip cover
- Professional appearance



Slotted Wall Duct

Slotted wall duct features break-away fingers which provide additional access for wire leads.

Slotted wall duct is manufactured with two score lines.

The first score line is at the base of the finger, allowing the finger to be bent and broken away when a greater opening is required. The second score line is lower allowing a section of the sidewall to be easily removed by cutting the sidewall down to the lower score line. Use HellermannTyton's TDNT notching tool and snap out the desired section. Both score lines provide smooth edges to ensure worker safety.

Strong fingers prevent unwanted breaking.

The fingers are easily deflected outward, allowing ready positioning of the wires within the slotted wall duct.

Restricted opening design in the finger of the duct helps keep wires in place.

Restriction also prevents unintended removal of wires and permits any individual wire to be traced without disconnection.



High Density Slotted Duct

High density slotted wall duct comes with narrow fingers, equaling a 2-to-1 finger ratio compared to standard slotted wiring duct.

Narrow fingers reduce fanning of the wires to the terminal blocks.

Compact designs and components are more easily accommodated with the high density duct's 2-to-1 finger ratio.

High density duct also incorporates the double scored design, similar to the standard slotted wall duct.

With sizes 2" high and above, high density duct features a double restriction on each finger of the duct.

The double restriction helps retain wires in the bottom portion of the duct for easier installation.

Mounting holes are uniform in size to the solid and slotted wall duct but are offered every 2 inches to accommodate compact designs and installations.



Adhesive Backing

Most sizes of Pro-Duct wiring duct are available with a pressure sensitive, rubber based adhesive backing. The adhesive backing can be utilized for temporary positioning or permanent mounting. This is an optional feature and must be specified when ordering. For part number information, contact HellermannTyton or see notation at the end of each duct dimensional chart.

Please note: Adhesive duct orders are non-cancellable and non-returnable.

Duct Width	Rows of Tape	Tape Width
.50"	1	3/8"
.75"	1	1/2"
1.0"	1	3/4"
1.5"	1	1-1/8"
2.0"	2	3/4"
3.0"	2	3/4"
4.0"	2	3/4"

Modular Packaging

Pro-Duct wiring duct is available in modular, easy to stock packaging. Each master carton contains 120 feet of duct divided into four inner cartons of 30 feet each. This better serves the inventory needs of users who require smaller quantities of several sizes. Due to weight restrictions, 3" x 5" and 4" x 5" sizes are only available in bulk packaging. To order modular packaging, remove the last digit "4" from the duct or cover part number.

Wiring Duct

Solid Wall Duct

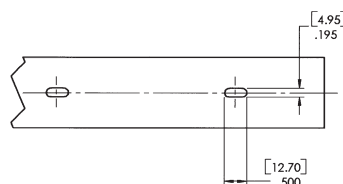
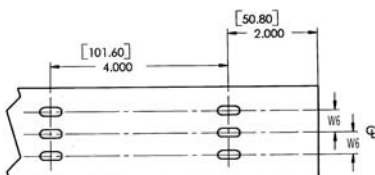
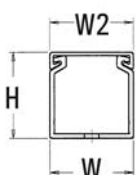

File # E64139 File # 49249

Product Selection			Width (W)	Height (H)	Width (W2)	Width (W6)	Description	Color	Pkg. Qty.
Article No.	Part No.	Type	in. (mm)	in. (mm)	in. (mm)	in. (mm)			ft. (6 ft. lengths)
.5" x .5" (12.7 x 12.7) Nominal Duct Size									
181-00453	SD.5X.5W4	SD.5X.5	.50" (12.7)	.55" (14.0)	.76" (19.3)	One row of holes on ☒	Non-Adhesive	White	120 ft
181-00525	SDA.5X.5W4	SDA.5X.5					Adhesive	White	120 ft
181-00452	SD.5X.5G4	SD.5X.5					Non-Adhesive	Gray	120 ft
181-00524	SDA.5X.5G4	SDA.5X.5					Adhesive	Gray	120 ft
181-05500	SD.5X.5BK4	SD.5X.5					Non-Adhesive	Black	120 ft
181-00481	SDA.5X.5BK4	SDA.5X.5					Adhesive	Black	120 ft
.5" x 1" (12.7 x 25.4) Nominal Duct Size									
181-00143	SD.5X1W4	SD.5X1	.50" (12.7)	1.05" (26.7)	.76" (19.3)	One row of holes on ☒	Non-Adhesive	White	120 ft
181-00528	SDA.5X1W4	SDA.5X1					Adhesive	White	120 ft
181-00145	SD.5X1G4	SD.5X1					Non-Adhesive	Gray	120 ft
181-00526	SDA.5X1G4	SDA.5X1					Adhesive	Gray	120 ft
181-00144	SD.5X1BK4	SD.5X1					Non-Adhesive	Black	120 ft
181-00527	SDA.5X1BK4	SDA.5X1					Adhesive	Black	120 ft
.75" x .75" (19.1 x 19.1) Nominal Duct Size									
181-00456	SD.75X.75W4	SD.75X.75	.75" (19.1)	.80" (20.3)	1.01" (25.7)	One row of holes on ☒	Non-Adhesive	White	120 ft
181-00142	SDA.75X.75W4	SDA.75X.75					Adhesive	White	120 ft
181-00455	SD.75X.75G4	SD.75X.75					Non-Adhesive	Gray	120 ft
181-00140	SDA.75X.75G4	SDA.75X.75					Adhesive	Gray	120 ft
181-00454	SD.75X.75BK4	SD.75X.75					Non-Adhesive	Black	120 ft
181-00141	SDA.75X.75BK4	SDA.75X.75					Adhesive	Black	120 ft
1" x 1" (25.4 x 25.4) Nominal Duct Size									
181-11005	SD1X1W4	SD1X1	1.00" (25.4)	1.05" (26.7)	1.00" (25.4)	One row of holes on ☒	Non-Adhesive	White	120 ft
181-11008	SDA1X1W4	SDA1X1					Adhesive	White	120 ft
181-11002	SD1X1G4	SD1X1					Non-Adhesive	Gray	120 ft
181-00493	SDA1X1G4	SDA1X1					Adhesive	Gray	120 ft
181-11000	SD1X1BK4	SD1X1					Non-Adhesive	Black	120 ft
181-00492	SDA1X1BK4	SDA1X1					Adhesive	Black	120 ft
1" x 1.5" (25.4 x 38.1) Nominal Duct Size									
181-11502	SD1X1.5W4	SD1X1.5	1.02" (25.9)	1.56" (39.6)	1.00" (25.4)	One row of holes on ☒	Non-Adhesive	White	120 ft
181-00491	SDA1X1.5W4	SDA1X1.5					Adhesive	White	120 ft
181-11501	SD1X1.5G4	SD1X1.5					Non-Adhesive	Gray	120 ft
181-00490	SDA1X1.5G4	SDA1X1.5					Adhesive	Gray	120 ft
181-00457	SD1X1.5BK4	SD1X1.5					Non-Adhesive	Black	120 ft
181-00529	SDA1X1.5BK4	SDA1X1.5					Adhesive	Black	120 ft

Dimensions are approximate and subject to technical changes. Use **Part No.** for ordering and **Type** for specification purposes.

Solid wall duct in larger sizes continued on the next page. Covers are listed on page 117.

Solid Wall Duct

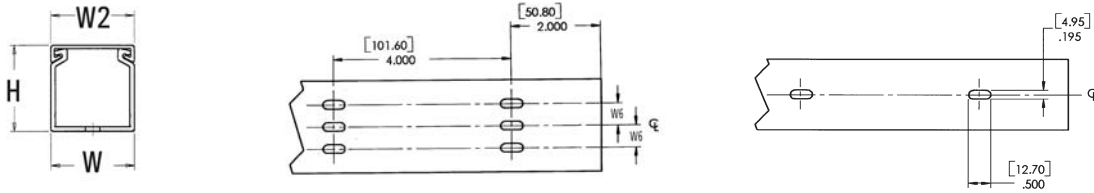

File # E64139 File # 49249

Product Selection			Width (W)	Height (H)	Width (W2)	Width (W6)	Description	Color	Pkg. Qty.
Article No.	Part No.	Type	in. (mm)	in. (mm)	in. (mm)	in. (mm)			ft. (6 ft. lengths)
1" x 2" (25.4 x 50.8) Nominal Duct Size									
181-12002	SD1X2W4	SD1X2	1.03" (26.2)	2.06" (52.3)	1.00" (25.4)	One row of holes on ⌀	Non-Adhesive	White	120 ft
181-00495	SDA1X2W4	SDA1X2					Adhesive	White	120 ft
181-12001	SD1X2G4	SD1X2					Non-Adhesive	Gray	120 ft
181-00494	SDA1X2G4	SDA1X2					Adhesive	Gray	120 ft
181-00458	SD1X2BK4	SD1X2					Non-Adhesive	Black	120 ft
181-00530	SDA1X2BK4	SDA1X2					Adhesive	Black	120 ft
1" x 3" (25.4 x 76.2) Nominal Duct Size									
181-13001	SD1X3W4	SD1X3	1.02" (25.9)	3.06" (77.7)	1.00" (25.4)	One row of holes on ⌀	Non-Adhesive	White	120 ft
181-00496	SDA1X3W4	SDA1X3					Adhesive	White	120 ft
181-00136	SD1X3G4	SD1X3					Non-Adhesive	Gray	120 ft
181-00671	SDA1X3G4	SDA1X3					Adhesive	Gray	120 ft
181-00459	SD1X3BK4	SD1X3					Non-Adhesive	Black	120 ft
181-00531	SDA1X3BK4	SDA1X3					Adhesive	Black	120 ft
1" x 4" (25.4 x 101.6) Nominal Duct Size									
181-14000	SD1X4W4	SD1X4	1.00" (25.4)	4.06" (103.1)	1.00" (25.4)	One row of holes on ⌀	Non-Adhesive	White	120 ft
181-00497	SDA1X4W4	SDA1X4					Adhesive	White	120 ft
181-00461	SD1X4G4	SD1X4					Non-Adhesive	Gray	120 ft
181-00533	SDA1X4G4	SDA1X4					Adhesive	Gray	120 ft
181-00460	SD1X4BK4	SD1X4					Non-Adhesive	Black	120 ft
181-00532	SDA1X4BK4	SDA1X4					Adhesive	Black	120 ft
1.5" x 1" (38.1 x 25.4) Nominal Duct Size									
181-15102	SD1.5X1W4	SD1.5X1	1.50" (38.1)	1.05" (26.7)	1.50" (38.1)	One row of holes on ⌀	Non-Adhesive	White	120 ft
181-00486	SDA1.5X1W4	SDA1.5X1					Adhesive	White	120 ft
181-15101	SD1.5X1G4	SD1.5X1					Non-Adhesive	Gray	120 ft
181-00025	SDA1.5X1G4	SDA1.5X1					Adhesive	Gray	120 ft
181-15100	SD1.5X1BK4	SD1.5X1					Non-Adhesive	Black	120 ft
181-00485	SDA1.5X1BK4	SDA1.5X1					Adhesive	Black	120 ft
1.5" x 1.5" (38.1 x 38.1) Nominal Duct Size									
181-15503	SD1.5X1.5W4	SD1.5X1.5	1.52" (38.6)	1.56" (39.6)	1.50" (38.1)	One row of holes on ⌀	Non-Adhesive	White	120 ft
181-15504	SDA1.5X1.5W4	SDA1.5X1.5					Adhesive	White	120 ft
181-15502	SD1.5X1.5G4	SD1.5X1.5					Non-Adhesive	Gray	120 ft
181-00483	SDA1.5X1.5G4	SDA1.5X1.5					Adhesive	Gray	120 ft
181-15500	SD1.5X1.5BK4	SD1.5X1.5					Non-Adhesive	Black	120 ft
181-00482	SDA1.5X1.5BK4	SDA1.5X1.5					Adhesive	Black	120 ft

Dimensions are approximate and subject to technical changes. Use **Part No.** for ordering and **Type** for specification purposes.

Solid wall duct in larger sizes continued on the next page. Covers are listed on page 117.

Wiring Duct

Solid Wall Duct

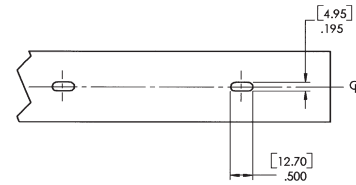
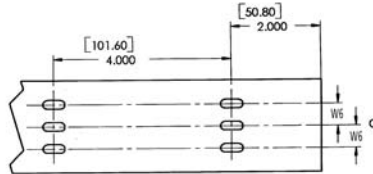
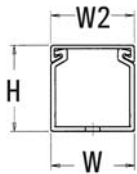

Product Selection			Width (W)	Height (H)	Width (W2)	Width (W6)	Description	Color	Pkg. Qty.
Article No.	Part No.	Type	in. (mm)	in. (mm)	in. (mm)	in. (mm)			ft. (6 ft. lengths)
1.5" x 2" (38.1 x 50.8) Nominal Duct Size									
181-15202	SD1.5X2W4	SD1.5X2	1.53" (38.9)	2.06" (52.3)	1.50" (38.1)	One row of holes on ⌀	Non-Adhesive	White	120 ft
181-00488	SDA1.5X2W4	SDA1.5X2					Adhesive	White	120 ft
181-15201	SD1.5X2G4	SD1.5X2					Non-Adhesive	Gray	120 ft
181-00487	SDA1.5X2G4	SDA1.5X2					Adhesive	Gray	120 ft
181-00462	SD1.5X2BK4	SD1.5X2					Non-Adhesive	Black	120 ft
181-00534	SDA1.5X2BK4	SDA1.5X2					Adhesive	Black	120 ft
1.5" x 3" (38.1 x 76.2) Nominal Duct Size									
181-00464	SD1.5X3W4	SD1.5X3	1.52" (38.6)	3.06" (77.7)	1.50" (38.1)	One row of holes on ⌀	Non-Adhesive	White	120 ft
181-00536	SDA1.5X3W4	SDA1.5X3					Adhesive	White	120 ft
181-15300	SD1.5X3G4	SD1.5X3					Non-Adhesive	Gray	120 ft
181-00489	SDA1.5X3G4	SDA1.5X3					Adhesive	Gray	120 ft
181-00463	SD1.5X3BK4	SD1.5X3					Non-Adhesive	Black	120 ft
181-00535	SDA1.5X3BK4	SDA1.5X3					Adhesive	Black	120 ft
1.5" x 4" (38.1 x 101.6) Nominal Duct Size									
181-00467	SD1.5X4W4	SD1.5X4	1.50" (38.1)	4.06" (103.1)	1.50" (38.1)	One row of holes on ⌀	Non-Adhesive	White	120 ft
181-00539	SDA1.5X4W4	SDA1.5X4					Adhesive	White	120 ft
181-00574	SD1.5X4G4	SD1.5X4					Non-Adhesive	Gray	120 ft
181-00538	SDA1.5X4G4	SDA1.5X4					Adhesive	Gray	120 ft
181-00465	SD1.5X4BK4	SD1.5X4					Non-Adhesive	Black	120 ft
181-00537	SDA1.5X4BK4	SDA1.5X4					Adhesive	Black	120 ft
2" x 1" (50.8 x 25.4) Nominal Duct Size									
181-21003	SD2X1W4	SD2X1	2.01" (51.1)	1.05" (26.7)	2.00" (50.8)	Three rows of holes .50" (12.7)	Non-Adhesive	White	120 ft
181-00500	SDA2X1W4	SDA2X1					Adhesive	White	120 ft
181-21001	SD2X1G4	SD2X1					Non-Adhesive	Gray	120 ft
181-00499	SDA2X1G4	SDA2X1					Adhesive	Gray	120 ft
181-21000	SD2X1BK4	SD2X1					Non-Adhesive	Black	120 ft
181-00498	SDA2X1BK4	SDA2X1					Adhesive	Black	120 ft
2" x 2" (50.8 x 50.8) Nominal Duct Size									
181-22013	SD2X2W4	SD2X2	2.03" (51.6)	2.06" (52.3)	2.00" (50.8)	Three rows of holes .50" (12.7)	Non-Adhesive	White	120 ft
181-22018	SDA2X2W4	SDA2X2					Adhesive	White	120 ft
181-22008	SD2X2G4	SD2X2					Non-Adhesive	Gray	120 ft
181-22016	SDA2X2G4	SDA2X2					Adhesive	Gray	120 ft
181-22005	SD2X2BK4	SD2X2					Non-Adhesive	Black	120 ft
181-00501	SDA2X2BK4	SDA2X2					Adhesive	Black	120 ft

Dimensions are approximate and subject to technical changes. Use **Part No.** for ordering and **Type** for specification purposes. Solid wall duct in larger sizes continued on the next page. Covers are listed on page 117.

Solid Wall Duct

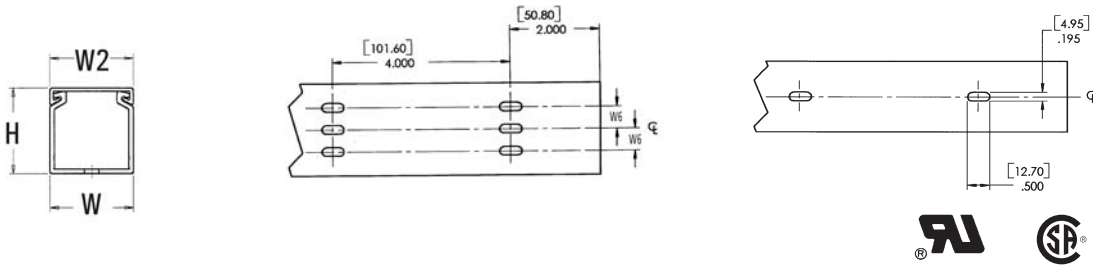

File # E64139 File # 49249

Product Selection			Width (W)	Height (H)	Width (W2)	Width (W6)	Description	Color	Pkg. Qty.
Article No.	Part No.	Type	in. (mm)	in. (mm)	in. (mm)	in. (mm)			ft. (6 ft. lengths)
2" x 3" (50.8 x 76.2) Nominal Duct Size									
181-23002	SD2X3W4	SD2X3	2.02" (51.3)	3.06" (77.7)	2.00" (50.8)	Three rows of holes .50" (12.7)	Non-Adhesive	White	120 ft
181-00504	SDA2X3W4	SDA2X3					Adhesive	White	120 ft
181-23001	SD2X3G4	SD2X3					Non-Adhesive	Gray	120 ft
181-00503	SDA2X3G4	SDA2X3					Adhesive	Gray	120 ft
181-00468	SD2X3BK4	SD2X3					Non-Adhesive	Black	120 ft
181-00540	SDA2X3BK4	SDA2X3					Adhesive	Black	120 ft
2" x 4" (50.8 x 101.6) Nominal Duct Size									
181-24002	SD2X4W4	SD2X4	2.00" (50.8)	4.06" (103.1)	2.00" (50.8)	Three rows of holes .50" (12.7)	Non-Adhesive	White	120 ft
181-00506	SDA2X4W4	SDA2X4					Adhesive	White	120 ft
181-24000	SD2X4G4	SD2X4					Non-Adhesive	Gray	120 ft
181-00505	SDA2X4G4	SDA2X4					Adhesive	Gray	120 ft
181-00469	SD2X4BK4	SD2X4					Non-Adhesive	Black	120 ft
181-00541	SDA2X4BK4	SDA2X4					Adhesive	Black	120 ft
3" x 1" (76.2 x 25.4) Nominal Duct Size									
181-31002	SD3X1W4	SD3X1	3.04" (77.2)	1.05" (26.7)	3.00" (76.2)	Three rows of holes 1.00" (25.4)	Non-Adhesive	White	120 ft
181-00508	SDA3X1W4	SDA3X1					Adhesive	White	120 ft
181-31001	SD3X1G4	SD3X1					Non-Adhesive	Gray	120 ft
181-00507	SDA3X1G4	SDA3X1					Adhesive	Gray	120 ft
181-00470	SD3X1BK4	SD3X1					Non-Adhesive	Black	120 ft
181-00672	SDA3X1BK4	SDA3X1					Adhesive	Black	120 ft
3" x 2" (76.2 x 50.8) Nominal Duct Size									
181-32003	SD3X2W4	SD3X2	3.03" (77.0)	2.06" (52.5)	3.00" (77.0)	Three rows of holes 1.00" (25.4)	Non-Adhesive	White	120 ft
181-00510	SDA3X2W4	SDA3X2					Adhesive	White	120 ft
181-32002	SD3X2G4	SD3X2					Non-Adhesive	Gray	120 ft
181-00509	SDA3X2G4	SDA3X2					Adhesive	Gray	120 ft
181-00471	SD3X2BK4	SD3X2					Non-Adhesive	Black	120 ft
181-00542	SDA3X2BK4	SDA3X2					Adhesive	Black	120 ft
3" x 3" (76.2 x 76.2) Nominal Duct Size									
181-33006	SD3X3W4	SD3X3	3.02" (76.7)	3.06" (77.7)	3.00" (76.2)	Three rows of holes 1.00" (25.4)	Non-Adhesive	White	120 ft
181-00513	SDA3X3W4	SDA3X3					Adhesive	White	120 ft
181-33004	SD3X3G4	SD3X3					Non-Adhesive	Gray	120 ft
181-00512	SDA3X3G4	SDA3X3					Adhesive	Gray	120 ft
181-33000	SD3X3BK4	SD3X3					Non-Adhesive	Black	120 ft
181-00511	SDA3X3BK4	SDA3X3					Adhesive	Black	120 ft
3" x 4" (76.2 x 101.6) Nominal Duct Size									
181-34001	SD3X4W4	SD3X4	3.00" (76.2)	4.06" (103.1)	3.00" (76.2)	Three rows of holes 1.00" (25.4)	Non-Adhesive	White	120 ft
181-00515	SDA3X4W4	SDA3X4					Adhesive	White	120 ft
181-34000	SD3X4G4	SD3X4					Non-Adhesive	Gray	120 ft
181-00514	SDA3X4G4	SDA3X4					Adhesive	Gray	120 ft
181-00472	SD3X4BK4	SD3X4					Non-Adhesive	Black	120 ft
181-00147	SDA3X4BK4	SDA3X4					Adhesive	Black	120 ft

Dimensions are approximate and subject to technical changes. Use **Part No.** for ordering and **Type** for specification purposes.

Solid wall duct in larger sizes continued on the next page. Covers are listed on page 117.

Wiring Duct

Solid Wall Duct

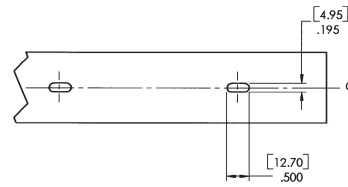
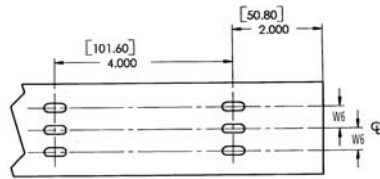

File # E64139 File # 49249

Product Selection			Width (W)	Height (H)	Width (W2)	Width (W6)	Description	Color	Pkg. Qty.
Article No.	Part No.	Type	in. (mm)	in. (mm)	in. (mm)	in. (mm)			ft. (6 ft. lengths)
3" x 5" (76.2 x 127.0) Nominal Duct Size									
181-00475	SD3X5W4	SD3X5	3.00" (76.2)	5.06" (128.5)	3.00" (76.2)	Three rows of holes 1.00" (25.4)	Non-Adhesive	White	120 ft
181-00544	SDA3X5W4	SDA3X5					Adhesive	White	120 ft
181-00474	SD3X5G4	SD3X5					Non-Adhesive	Gray	120 ft
181-00148	SDA3X5G4	SDA3X5					Adhesive	Gray	120 ft
181-00473	SD3X5BK4	SD3X5					Non-Adhesive	Black	120 ft
181-00543	SDA3X5BK4	SDA3X5					Adhesive	Black	120 ft
4" x 2" (101.6 x 50.8) Nominal Duct Size									
181-42004	SD4X2W4	SD4X2	4.03" (102.4)	2.06" (52.3)	4.00" (101.6)	Three rows of holes 1.50" (38.1)	Non-Adhesive	White	120 ft
181-00517	SDA4X2W4	SDA4X2					Adhesive	White	120 ft
181-42002	SD4X2G4	SD4X2					Non-Adhesive	Gray	120 ft
181-00516	SDA4X2G4	SDA4X2					Adhesive	Gray	120 ft
181-00476	SD4X2BK4	SD4X2					Non-Adhesive	Black	120 ft
181-00545	SDA4X2BK4	SDA4X2					Adhesive	Black	120 ft
4" x 3" (101.6 x 76.2) Nominal Duct Size									
181-43002	SD4X3W4	SD4X3	4.03" (102.4)	3.06" (77.7)	4.00" (101.6)	Three rows of holes 1.50" (38.1)	Non-Adhesive	White	120 ft
181-00519	SDA4X3W4	SDA4X3					Adhesive	White	120 ft
181-43001	SD4X3G4	SD4X3					Non-Adhesive	Gray	120 ft
181-00518	SDA4X3G4	SDA4X3					Adhesive	Gray	120 ft
181-00477	SD4X3BK4	SD4X3					Non-Adhesive	Black	120 ft
181-00546	SDA4X3BK4	SDA4X3					Adhesive	Black	120 ft
4" x 4" (101.6 x 101.6) Nominal Duct Size									
181-44015	SD4X4W4	SD4X4	4.00" (101.6)	4.06" (103.1)	4.00" (101.6)	Three rows of holes 1.50" (38.1)	Non-Adhesive	White	120 ft
181-00521	SDA4X4W4	SDA4X4					Adhesive	White	120 ft
181-44009	SD4X4G4	SD4X4					Non-Adhesive	Gray	120 ft
181-44018	SDA4X4G4	SDA4X4					Adhesive	Gray	120 ft
181-44006	SD4X4BK4	SD4X4					Non-Adhesive	Black	120 ft
181-00520	SDA4X4BK4	SDA4X4					Adhesive	Black	120 ft
4" x 5" (101.6 x 127) Nominal Duct Size									
181-45001	SD4X5W4	SD4X5	4.00" (101.6)	5.06" (128.5)	4.00" (101.6)	Three rows of holes 1.50" (38.1)	Non-Adhesive	White	60 ft
181-00523	SDA4X5W4	SDA4X5					Adhesive	White	60 ft
181-45000	SD4X5G4	SD4X5					Non-Adhesive	Gray	60 ft
181-00522	SDA4X5G4	SDA4X5					Adhesive	Gray	60 ft
181-00137	SD4X5BK4	SD4X5					Non-Adhesive	Black	60 ft
181-00547	SDA4X5BK4	SDA4X5					Adhesive	Black	60 ft
6" x 4" (152.4 x 101.6) Nominal Duct Size									
181-64001	SD6X4W4	SD6X4	6.00" (152.4)	4.07" (103.4)	6.00" (152.4)	No mounting holes	Non-Adhesive	White	60 ft
181-64000	SD6X4G4	SD6X4					Non-Adhesive	Gray	60 ft
181-00479	SD6X4BK4	SD6X4					Non-Adhesive	Black	60 ft
8" x 4" (203.2 x 101.6) Nominal Duct Size									
181-84007	SD8X4W4	SD8X4	8.00" (203.2)	4.09" (103.9)	8.00" (203.2)	No mounting holes	Non-Adhesive	White	60 ft
181-84004	SD8X4G4	SD8X4					Non-Adhesive	Gray	60 ft
181-00480	SD8X4BK4	SD8X4					Non-Adhesive	Black	60 ft

Dimensions are approximate and subject to technical changes. Use **Part No.** for ordering and **Type** for specification purposes. Covers are listed on page 117.

Slotted Wall Duct

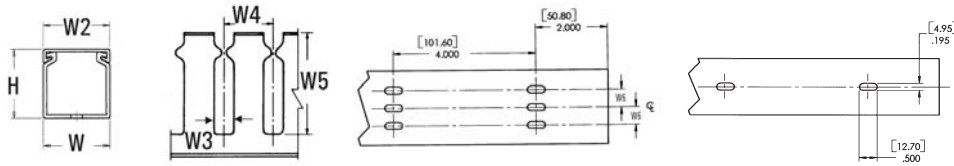

File # E64139 File # 49249

Product Selection			Width (W)	Height (H)	Width (W2)	Width (W3)	Width (W4)	Width (W5)	Width (W6)	Description	Color	Pkg. Qty. ft. (6 ft. lengths)
Article No.	Part No.	Type	in. (mm)	in. (mm)	in. (mm)	in. (mm)	in. (mm)	in. (mm)	in. (mm)			
1" x 1" (25.4 x 25.4) Nominal Duct Size												
181-11015	SL1X1W4	SL1X1	1.00" (25.4)	1.05" (26.7)	1.00" (25.4)	.40" (10.2)	1.00" (25.40)	.75" (19.05)	One row of holes on ⌀	Non-Adhesive	White	120 ft
181-11021	SLA1X1W4	SLA1X1								Adhesive	White	120 ft
181-11013	SL1X1G4	SL1X1								Non-Adhesive	Gray	120 ft
181-11019	SLA1X1G4	SLA1X1								Adhesive	Gray	120 ft
181-11009	SL1X1BK4	SL1X1								Non-Adhesive	Black	120 ft
181-11016	SLA1X1BK4	SLA1X1								Adhesive	Black	120 ft
1" x 1.5" (25.4 x 38.1) Nominal Duct Size												
181-11507	SL1X1.5W4	SL1X1.5	1.02" (25.91)	1.56" (26.1)	1.00" (25.40)	.40" (10.16)	1.00" (25.40)	1.19" (30.2)	One row of holes on ⌀	Non-Adhesive	White	120 ft
181-11511	SLA1X1.5W4	SLA1X1.5								Adhesive	White	120 ft
181-11505	SL1X1.5G4	SL1X1.5								Non-Adhesive	Gray	120 ft
181-11509	SLA1X1.5G4	SLA1X1.5								Adhesive	Gray	120 ft
181-00552	SL1X1.5BK4	SL1X1.5								Non-Adhesive	Black	120 ft
181-00564	SLA1X1.5BK4	SLA1X1.5								Adhesive	Black	120 ft
1" x 2" (25.4 x 50.8) Nominal Duct Size												
181-12008	SL1X2W4	SL1X2	1.03" (26.16)	2.06" (52.32)	1.00" (25.40)	.40" (10.16)	1.00" (25.40)	1.62" (41.1)	One row of holes on ⌀	Non-Adhesive	White	120 ft
181-12013	SLA1X2W4	SLA1X2								Adhesive	White	120 ft
181-12005	SL1X2G4	SL1X2								Non-Adhesive	Gray	120 ft
181-12011	SLA1X2G4	SLA1X2								Adhesive	Gray	120 ft
181-00024	SL1X2BK4	SL1X2								Non-Adhesive	Black	120 ft
181-00565	SLA1X2BK4	SLA1X2								Adhesive	Black	120 ft
1" x 3" (25.4 x 76.2) Nominal Duct Size												
181-13008	SL1X3W4	SL1X3	1.02" (25.91)	3.06" (77.72)	1.00" (25.40)	.40" (10.16)	1.00" (25.40)	2.60" (66.0)	One row of holes on ⌀	Non-Adhesive	White	120 ft
181-13012	SLA1X3W4	SLA1X3								Adhesive	White	120 ft
181-13006	SL1X3G4	SL1X3								Non-Adhesive	Gray	120 ft
181-13010	SLA1X3G4	SLA1X3								Adhesive	Gray	120 ft
181-13003	SL1X3BK4	SL1X3								Non-Adhesive	Black	120 ft
181-00566	SLA1X3BK4	SLA1X3								Adhesive	Black	120 ft
1" x 4" (25.4 x 101.6) Nominal Duct Size												
181-14006	SL1X4W4	SL1X4	1.00" (25.40)	4.06" (103.12)	1.00" (25.40)	.40" (10.16)	1.00" (25.40)	3.6" (91.4)	One row of holes on ⌀	Non-Adhesive	White	120 ft
181-00569	SLA1X4W4	SLA1X4								Adhesive	White	120 ft
181-14003	SL1X4G4	SL1X4								Non-Adhesive	Gray	120 ft
181-00568	SLA1X4G4	SLA1X4								Adhesive	Gray	120 ft
181-14001	SL1X4BK4	SL1X4								Non-Adhesive	Black	120 ft
181-00567	SLA1X4BK4	SLA1X4								Adhesive	Black	120 ft
1.5" x 1" (38.1 x 25.4) Nominal Duct Size												
181-15107	SL1.5X1W4	SL1.5X1	1.50" (38.10)	1.05" (26.67)	1.50" (38.10)	.40" (10.16)	1.00" (25.40)	.75" (19.1)	One row of holes on ⌀	Non-Adhesive	White	120 ft
181-00572	SLA1.5X1W4	SLA1.5X1								Adhesive	White	120 ft
181-15105	SL1.5X1G4	SL1.5X1								Non-Adhesive	Gray	120 ft
181-00571	SLA1.5X1G4	SLA1.5X1								Adhesive	Gray	120 ft
181-00548	SL1.5X1BK4	SL1.5X1								Non-Adhesive	Black	120 ft
181-00570	SLA1.5X1BK4	SLA1.5X1								Adhesive	Black	120 ft

Dimensions are approximate and subject to technical changes. Use **Part No.** for ordering and **Type** for specification purposes. Slotted wall duct in larger sizes continued on the next page. Covers are listed on page 117.

Wiring Duct

Slotted Wall Duct

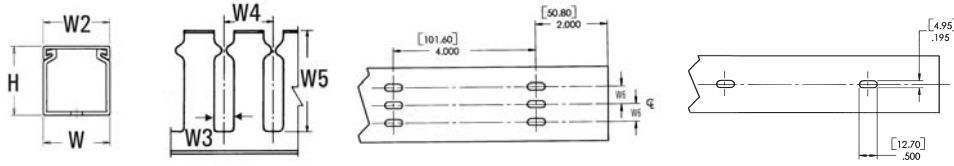

Product Selection			Width (W)	Height (H)	Width (W2)	Width (W3)	Width (W4)	Width (W5)	Width (W6)	Description	Color	Pkg. Qty.
Article No.	Part No.	Type	in. (mm)	in. (mm)	in. (mm)	in. (mm)	in. (mm)	in. (mm)	in. (mm)			ft. (6 ft. lengths)
1.5" x 1.5" (38.1 x 38.1) Nominal Duct Size												
181-15511	SL1.5X1.5W4	SL1.5X1.5	1.52" (38.61)	1.56" (34.6)	1.50" (38.10)	.40" (10.16)	1.00" (25.40)	1.19" (30.2)	One row of holes on ⌀	Non-Adhesive	White	120 ft
181-15515	SLA1.5X1.5W4	SLA1.5X1.5								Adhesive	White	120 ft
181-15509	SL1.5X1.5G4	SL1.5X1.5								Non-Adhesive	Gray	120 ft
181-15513	SLA1.5X1.5G4	SLA1.5X1.5								Adhesive	Gray	120 ft
181-15505	SL1.5X1.5BK4	SL1.5X1.5								Non-Adhesive	Black	120 ft
181-00027	SLA1.5X1.5BK4	SLA1.5X1.5								Adhesive	Black	120 ft
1.5" x 2" (38.1 x 50.8) Nominal Duct Size												
181-15209	SL1.5X2W4	SL1.5X2	1.53" (38.86)	2.06" (52.32)	1.50" (38.10)	.40" (10.16)	1.00" (25.40)	1.62" (41.1)	One row of holes on ⌀	Non-Adhesive	White	120 ft
181-15213	SLA1.5X2W4	SLA1.5X2								Adhesive	White	120 ft
181-15207	SL1.5X2G4	SL1.5X2								Non-Adhesive	Gray	120 ft
181-15211	SLA1.5X2G4	SLA1.5X2								Adhesive	Gray	120 ft
181-15203	SL1.5X2BK4	SL1.5X2								Non-Adhesive	Black	120 ft
181-00573	SLA1.5X2BK4	SLA1.5X2								Adhesive	Black	120 ft
1.5" x 3" (38.1 x 76.2) Nominal Duct Size												
181-15306	SL1.5X3W4	SL1.5X3	1.52" (38.61)	3.06" (77.72)	1.50" (38.10)	.40" (10.16)	1.00" (25.40)	2.60" (66.0)	One row of holes on ⌀	Non-Adhesive	White	120 ft
181-15308	SLA1.5X3W4	SLA1.5X3								Adhesive	White	120 ft
181-15304	SL1.5X3G4	SL1.5X3								Non-Adhesive	Gray	120 ft
181-15307	SLA1.5X3G4	SLA1.5X3								Adhesive	Gray	120 ft
181-00550	SL1.5X3BK4	SL1.5X3								Non-Adhesive	Black	120 ft
181-00575	SLA1.5X3BK4	SLA1.5X3								Adhesive	Black	120 ft
1.5" x 4" (38.1 x 101.6) Nominal Duct Size												
181-15406	SL1.5X4W4	SL1.5X4	1.50" (38.10)	4.06" (103.12)	1.50" (38.10)	.40" (10.16)	1.00" (25.40)	3.60" (91.40)	One row of holes on ⌀	Non-Adhesive	White	120 ft
181-00578	SLA1.5X4W4	SLA1.5X4								Adhesive	White	120 ft
181-15404	SL1.5X4G4	SL1.5X4								Non-Adhesive	Gray	120 ft
181-00577	SLA1.5X4G4	SLA1.5X4								Adhesive	Gray	120 ft
181-15400	SL1.5X4BK4	SL1.5X4								Non-Adhesive	Black	120 ft
181-00576	SLA1.5X4BK4	SLA1.5X4								Adhesive	Black	120 ft
2" x 1" (50.8 x 25.4) Nominal Duct Size												
181-21007	SL2X1W4	SL2X1	2.01" (51.05)	1.05" (26.7)	2.00" (50.80)	.40" (10.16)	1.00" (25.40)	.75" (19.1)	Three rows of holes .50" (12.7)	Non-Adhesive	White	120 ft
181-00580	SLA2X1W4	SLA2X1								Adhesive	White	120 ft
181-21005	SL2X1G4	SL2X1								Non-Adhesive	Gray	120 ft
181-21009	SLA2X1G4	SLA2X1								Adhesive	Gray	120 ft
181-00554	SL2X1BK4	SL2X1								Non-Adhesive	Black	120 ft
181-00579	SLA2X1BK4	SLA2X1								Adhesive	Black	120 ft
2" x 2" (50.8 x 50.8) Nominal Duct Size												
181-22028	SL2X2W4	SL2x2	2.03" (51.56)	2.00" (50.80)	2.00" (50.80)	.40" (10.16)	1.00" (25.40)	1.62" (41.1)	Three rows of holes .50" (12.7)	Non-Adhesive	White	120 ft
181-22034	SLA2X2W4	SLA2X2								Adhesive	White	120 ft
181-22024	SL2X2G4	SL2x2								Non-Adhesive	Gray	120 ft
181-22032	SLA2X2G4	SLA2X2								Adhesive	Gray	120 ft
181-22020	SL2X2BK4	SL2x2								Non-Adhesive	Black	120 ft
181-22030	SLA2X2BK4	SLA2X2								Adhesive	Black	120 ft

Dimensions are approximate and subject to technical changes. Use **Part No.** for ordering and **Type** for specification purposes.

Slotted wall duct in larger sizes continued on the next page. Covers are listed on page 117.

Slotted Wall Duct

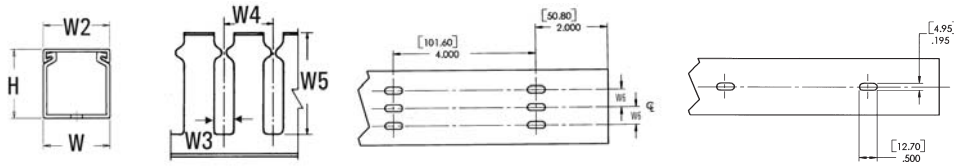

File # E64139 File # 49249

Product Selection												
Article No.	Part No.	Type	Width (W)	Height (H)	Width (W2)	Width (W3)	Width (W4)	Width (W5)	Width (W6)	Description	Color	Pkg. Qty.
			in. (mm)	in. (mm)	in. (mm)	in. (mm)	in. (mm)	in. (mm)	in. (mm)			ft. (6 ft. lengths)
2" x 3" (50.8 x 76.2) Nominal Duct Size												
181-23009	SL2X3W4	SL2X3	2.02" (51.31)	3.00" (76.20)	2.00" (50.80)	.40" (10.16)	1.00" (25.40)	2.60" (66.0)	Three rows of holes .50" (12.7)	Non-Adhesive	White	120 ft
181-23012	SLA2X3W4	SLA2X3								Adhesive	White	120 ft
181-23007	SL2X3G4	SL2X3								Non-Adhesive	Gray	120 ft
181-00582	SLA2X3G4	SAL2X3								Adhesive	Gray	120 ft
181-23003	SL2X3BK4	SL2X3								Non-Adhesive	Black	120 ft
181-00581	SLA2X3BK4	SAL2X3								Adhesive	Black	120 ft
2" x 4" (50.8 x 101.6) Nominal Duct Size												
181-24011	SL2X4W4	SL2X4	2.00" (50.80)	4.06" (103.1)	2.00" (50.80)	.40" (10.16)	1.00" (25.40)	3.60" (91.4)	Three rows of holes .50" (12.7)	Non-Adhesive	White	120 ft
181-24014	SLA2X4W4	SLA2X4								Adhesive	White	120 ft
181-24008	SL2X4G4	SL2X4								Non-Adhesive	Gray	120 ft
181-24013	SLA2X4G4	SLA2X4								Adhesive	Gray	120 ft
181-24003	SL2X4BK4	SL2X4								Non-Adhesive	Black	120 ft
181-00583	SLA2X4BK4	SLA2X4								Adhesive	Black	120 ft
3" x 1" (50.8 x 101.6) Nominal Duct Size												
181-31007	SL3X1W4	SL3X1	3.04" (77.22)	1.00" (25.4)	3.00" (76.20)	.40" (10.16)	1.00" (25.40)	.75" (19.1)	Three rows of holes 1.00" (25.4)	Non-Adhesive	White	120 ft
181-00586	SLA3X1W4	SLA3X1								Adhesive	White	120 ft
181-00558	SL3X1G4	SL3X1								Non-Adhesive	Gray	120 ft
181-00585	SLA3X1G4	SLA3X1								Adhesive	Gray	120 ft
181-00557	SL3X1BK4	SL3X1								Non-Adhesive	Black	120 ft
181-00584	SLA3X1BK4	SLA3X1								Adhesive	Black	120 ft
3" x 2" (76.2 x 50.8) Nominal Duct Size												
181-32009	SL3X2W4	SL3X2	3.03" (76.96)	2.00" (50.80)	3.00" (76.20)	.40" (10.16)	1.00" (25.40)	1.62" (41.1)	Three rows of holes 1.00" (25.4)	Non-Adhesive	White	120 ft
181-32015	SLA3X2W4	SLA3X2								Adhesive	White	120 ft
181-32006	SL3X2G4	SL3X2								Non-Adhesive	Gray	120 ft
181-32012	SLA3X2G4	SLA3X2								Adhesive	Gray	120 ft
181-32004	SL3X2BK4	SL3X2								Non-Adhesive	Black	120 ft
181-00587	SLA3X2BK4	SLA3X2								Adhesive	Black	120 ft
3" x 3" (76.2 x 76.2) Nominal Duct Size												
181-33018	SL3X3W4	SL3X3	3.02" (76.71)	3.00" (76.20)	3.00" (76.20)	.40" (10.16)	1.00" (25.40)	2.60" (66.0)	Three rows of holes 1.00" (25.4)	Non-Adhesive	White	120 ft
181-33023	SLA3X3W4	SLA3X3								Adhesive	White	120 ft
181-33016	SL3X3G4	SL3X3								Non-Adhesive	Gray	120 ft
181-33021	SLA3X3G4	SLA3X3								Adhesive	Gray	120 ft
181-33009	SL3X3BK4	SL3X3								Non-Adhesive	Black	120 ft
181-00159	SLA3X3BK4	SLA3X3								Adhesive	Black	120 ft
3" x 4" (76.2 x 101.6) Nominal Duct Size												
181-34007	SL3X4W4	SL3X4	3.00" (76.20)	4.00" (101.60)	3.00" (76.20)	.40" (10.16)	1.00" (25.40)	3.60" (91.4)	Three rows of holes 1.00" (25.4)	Non-Adhesive	White	120 ft
181-00590	SLA3X4W4	SLA3X4								Adhesive	White	120 ft
181-34004	SL3X4G4	SL3X4								Non-Adhesive	Gray	120 ft
181-00589	SLA3X4G4	SLA3X4								Adhesive	Gray	120 ft
181-34002	SL3X4BK4	SL3X4								Non-Adhesive	Black	120 ft
181-00588	SLA3X4BK4	SLA3X4								Adhesive	Black	120 ft

Dimensions are approximate and subject to technical changes. Use **Part No.** for ordering and **Type** for specification purposes. Slotted wall duct in larger sizes continued on the next page. Covers are listed on page 117.

Slotted Wall Duct

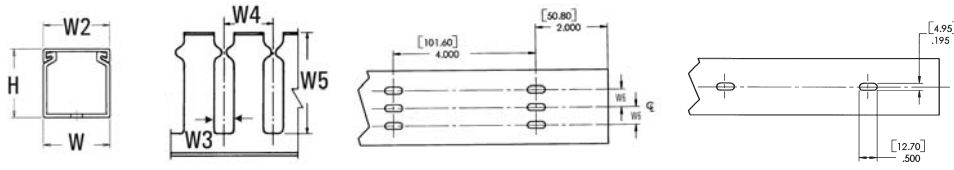

Product Selection												
Article No.	Part No.	Type	Width (W)	Height (H)	Width (W2)	Width (W3)	Width (W4)	Width (W5)	Width (W6)	Description	Color	Pkg. Qty.
			in. (mm)	in. (mm)	in. (mm)	in. (mm)	in. (mm)	in. (mm)	in. (mm)			ft. (6 ft. lengths)
3" x 5" (76.2 x 127.0) Nominal Duct Size												
181-00560	SL3X5W4	SL3X5	3.00" (76.20)	5.00" (127.00)	3.00" (76.20)	.40" (10.16)	1.00" (25.40)	4.60" (116.8)	Three rows of holes 1.00" (25.4)	Non-Adhesive	White	120 ft
181-00156	SLA3X5G4	SLA3X5								Adhesive	White	120 ft
181-35005	SL3X5G4	SL3X5								Non-Adhesive	Gray	120 ft
181-00155	SLA3X5G4	SLA3X5								Adhesive	Gray	120 ft
181-35002	SL3X5BK4	SL3X5								Non-Adhesive	Black	120 ft
181-00157	SLA3X5BK4	SLA3X5								Adhesive	Black	120 ft
4" x 2" (101.6 x 50.8) Nominal Duct Size												
181-42010	SL4X2W4	SL4X2	4.03" (102.36)	2.06" (52.3)	4.00" (101.60)	.40" (10.16)	1.00" (25.40)	1.62" (41.1)	Three rows of holes 1.50" (38.1)	Non-Adhesive	White	120 ft
181-42014	SLA4X2W4	SLA4X2								Adhesive	White	120 ft
181-42008	SL4X2G4	SL4X2								Non-Adhesive	Gray	120 ft
181-00592	SLA4X2G4	SLA4X2								Adhesive	Gray	120 ft
181-42005	SL4X2BK4	SL4X2								Non-Adhesive	Black	120 ft
181-00591	SLA4X2BK4	SLA4X2								Adhesive	Black	120 ft
4" x 3" (101.6 x 76.2) Nominal Duct Size												
181-43006	SL4X3W4	SL4X3	4.03" (102.36)	3.00" (76.20)	4.00" (101.60)	.40" (10.16)	1.00" (25.40)	2.60" (66.0)	Three rows of holes 1.50" (38.1)	Non-Adhesive	White	120 ft
181-00594	SLA4X3W4	SLA4X3								Adhesive	White	120 ft
181-43004	SL4X3G4	SL4X3								Non-Adhesive	Gray	120 ft
181-43008	SLA4X3G4	SLA4X3								Adhesive	Gray	120 ft
181-00562	SL4X3BK4	SL4X3								Non-Adhesive	Black	120 ft
181-00593	SLA4X3BK4	SLA4X3								Adhesive	Black	120 ft
4" x 4" (101.6 x 101.6) Nominal Duct Size												
181-44031	SL4X4W4	SL4X4	4.00" (101.60)	4.00" (101.60)	4.00" (101.60)	.40" (10.16)	1.00" (25.40)	3.60" (91.4)	Three rows of holes 1.50" (38.1)	Non-Adhesive	White	120 ft
181-44035	SLA4X4W4	SLA4X4								Adhesive	White	120 ft
181-44027	SL4X4G4	SL4X4								Non-Adhesive	Gray	120 ft
181-44033	SLA4X4G4	SLA4X4								Adhesive	Gray	120 ft
181-44020	SL4X4BK4	SL4X4								Non-Adhesive	Black	120 ft
181-00595	SLA4X4BK4	SLA4X4								Adhesive	Black	120 ft
4" x 5" (101.6 x 127) Nominal Duct Size												
181-45011	SL4X5W4	SL4X5	4.00" (101.60)	5.06" (128.52)	4.00" (101.60)	.40" (10.16)	1.00" (25.40)	4.60" (116.8)	Three rows of holes 1.50" (38.1)	Non-Adhesive	White	60 ft
181-45013	SLA4X5W4	SLA4X5								Adhesive	White	60 ft
181-45010	SL4X5G4	SL4X5								Non-Adhesive	Gray	60 ft
181-00596	SLA4X5G4	SLA4X5								Adhesive	Gray	60 ft
181-45002	SL4X5BK4	SL4X5								Non-Adhesive	Black	60 ft
181-45012	SLA4X5BK4	SLA4X5								Adhesive	Black	60 ft

Dimensions are approximate and subject to technical changes. Use **Part No.** for ordering and **Type** for specification purposes.

Covers are listed on page 117.

High Density Slotted Duct

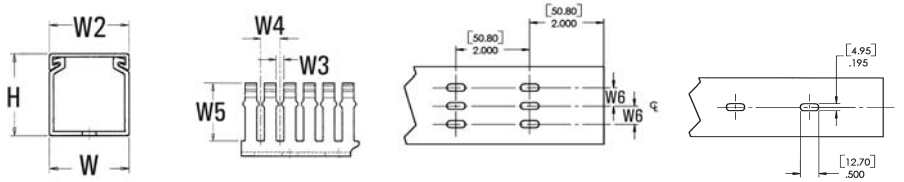

File # E64139 File # 49249

Product Selection			Width (W)	Height (H)	Width (W2)	Width (W3)	Width (W4)	Width (W5)	Width (W6)	Description	Color	Pkg. Qty. ft. (6 ft. lengths)
Article No.	Part No.	Type	in. (mm)	in. (mm)	in. (mm)	in. (mm)	in. (mm)	in. (mm)	in. (mm)			
1" x 1" (25.4 x 25.4) Nominal Duct Size												
184-11006	SLHD1X1W4	SLHD1X1	1.00" (25.4)	1.05" (26.7)	1.00" (25.4)	.16" (4.1)	.40" (10.2)	.75" (19.1)	One row of holes on Φ	Non-Adhesive	White	120 ft
181-00622	SLHDA1X1W4	SLHDA1X1								Adhesive	White	120 ft
184-11004	SLHD1X1G4	SLHD1X1								Non-Adhesive	Gray	120 ft
181-00621	SLHDA1X1G4	SLHDA1X1								Adhesive	Gray	120 ft
181-00597	SLHD1X1BK4	SLHD1X1								Non-Adhesive	Black	120 ft
181-00637	SLHDA1X1BK4	SLHDA1X1								Adhesive	Black	120 ft
1" x 1.5" (25.4 x 38.1) Nominal Duct Size												
184-11012	SLHD1X1.5W4	SLHD1X1.5	1.02" (25.9)	1.56" (39.6)	1.00" (25.4)	.16" (4.1)	.40" (10.2)	1.19" (30.2)	One row of holes on Φ	Non-Adhesive	White	120 ft
184-11009	SLHDA1X1.5W4	SLHDA1X1.5								Adhesive	White	120 ft
184-11010	SLHD1X1.5G4	SLHD1X1.5								Non-Adhesive	Gray	120 ft
184-11008	SLHDA1X1.5G4	SLHDA1X1.5								Adhesive	Gray	120 ft
181-00598	SLHD1X1.5BK4	SLHD1X1.5								Non-Adhesive	Black	120 ft
181-00623	SLHDA1X1.5BK4	SLHDA1X1.5								Adhesive	Black	120 ft
1" x 2" (25.4 x 50.8) Nominal Duct Size												
184-12007	SLHD1X2W4	SLHD1X2	1.03" (26.2)	2.06" (52.3)	1.00" (25.4)	.16" (4.1)	.40" (10.2)	1.62" (41.1)	One row of holes on Φ	Non-Adhesive	White	120 ft
184-12004	SLHDA1X2W4	SLHDA1X2								Adhesive	White	120 ft
184-12005	SLHD1X2G4	SLHD1X2								Non-Adhesive	Gray	120 ft
184-12002	SLHDA1X2G4	SLHDA1X2								Adhesive	Gray	120 ft
181-00599	SLHD1X2BK4	SLHD1X2								Non-Adhesive	Black	120 ft
181-00624	SLHDA1X2BK4	SLHDA1X2								Adhesive	Black	120 ft
1" x 3" (25.4 x 76.2) Nominal Duct Size												
184-13007	SLHD1X3W4	SLHD1X3	1.02" (25.9)	3.06" (77.7)	1.00" (25.4)	.16" (4.1)	.40" (10.2)	2.60" (66.0)	One row of holes on Φ	Non-Adhesive	White	120 ft
184-13003	SLHDA1X3W4	SLHDA1X3								Adhesive	White	120 ft
184-13005	SLHD1X3G4	SLHD1X3								Non-Adhesive	Gray	120 ft
181-00626	SLHDA1X3G4	SLHDA1X3								Adhesive	Gray	120 ft
181-00600	SLHD1X3BK4	SLHD1X3								Non-Adhesive	Black	120 ft
181-00625	SLHDA1X3BK4	SLHDA1X3								Adhesive	Black	120 ft
1" x 4" (25.4 x 101.6) Nominal Duct Size												
184-14004	SLHD1X4W4	SLHD1X4	1.00" (25.4)	4.06" (103.1)	1.00" (25.4)	.16" (4.1)	.40" (10.2)	3.60" (91.4)	One row of holes on Φ	Non-Adhesive	White	120 ft
181-00629	SLHDA1X4W4	SLHDA1X4								Adhesive	White	120 ft
184-14002	SLHD1X4G4	SLHD1X4								Non-Adhesive	Gray	120 ft
181-00628	SLHDA1X4G4	SLHDA1X4								Adhesive	Gray	120 ft
181-00601	SLHD1X4BK4	SLHD1X4								Non-Adhesive	Black	120 ft
181-00627	SLHDA1X4BK4	SLHDA1X4								Adhesive	Black	120 ft
1.5" x 1" (38.1 x 25.4) Nominal Duct Size												
184-15102	SLHD1.5X1W4	SLHD1.5X1	1.50" (38.1)	1.05" (26.7)	1.50" (38.1)	.16" (4.1)	.40" (10.2)	.75" (19.1)	One row of holes on Φ	Non-Adhesive	White	120 ft
181-00632	SLHDA1.5X1W4	SLHDA1.5X1								Adhesive	White	120 ft
184-15101	SLHD1.5X1G4	SLHD1.5X1								Non-Adhesive	Gray	120 ft
181-00631	SLHDA1.5X1G4	SLHDA1.5X1								Adhesive	Gray	120 ft
181-00602	SLHD1.5X1BK4	SLHD1.5X1								Non-Adhesive	Black	120 ft
181-00630	SLHDA1.5X1BK4	SLHDA1.5X1								Adhesive	Black	120 ft

Dimensions are approximate and subject to technical changes. Use **Part No.** for ordering and **Type** for specification purposes.

High density slotted wall duct in larger sizes continued on the next page. Covers are listed on page 117.

Wiring Duct

High Density Slotted Duct

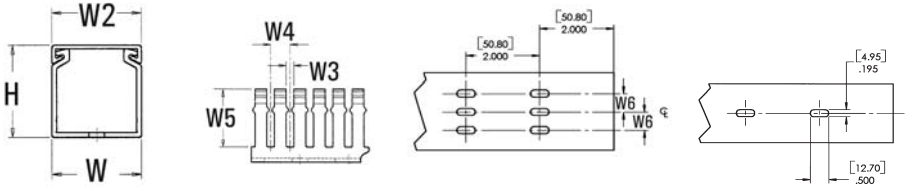



 File # E64139 File # 49249

Product Selection												
Article No.	Part No.	Type	Width (W)	Height (H)	Width (W2)	Width (W3)	Width (W4)	Width (W5)	Width (W6)	Description	Color	Pkg. Qty. ft. (6 ft. lengths)
			in. (mm)	in. (mm)	in. (mm)	in. (mm)	in. (mm)	in. (mm)	in. (mm)			
1.5" x 1.5" (38.1 x 38.1) Nominal Duct Size												
184-15155	SLHD1.5X1.5W4	SLHD1.5X1.5	1.52" (38.6)	1.56" (39.6)	1.50" (38.1)	.16" (4.1)	.40" (10.2)	1.19" (30.2)	One row of holes on Φ	Non-Adhesive	White	120 ft
184-15153	SLHDA1.5X1.5W4	SLHDA1.5X1.5								Adhesive	White	120 ft
184-15152	SLHD1.5X1.5G4	SLHD1.5X1.5								Non-Adhesive	Gray	120 ft
184-15151	SLHDA1.5X1.5G4	SLHDA1.5X1.5								Adhesive	Gray	120 ft
181-00603	SLHD1.5X1.5BK4	SLHD1.5X1.5								Non-Adhesive	Black	120 ft
181-00633	SLHDA1.5X1.5BK4	SLHD1.5X1.5								Adhesive	Black	120 ft
1.5" x 2" (38.1 x 50.8) Nominal Duct Size												
184-15206	SLHD1.5X2W4	SLHD1.5X2	1.53" (38.9)	2.06" (52.3)	1.50" (38.1)	.16" (4.1)	.40" (10.2)	1.62" (41.1)	One row of holes on Φ	Non-Adhesive	White	120 ft
184-15205	SLHDA1.5X2W4	SLHDA1.5X2								Adhesive	White	120 ft
184-15202	SLHD1.5X2G4	SLHD1.5X2								Non-Adhesive	Gray	120 ft
184-15201	SLHDA1.5X2G4	SLHDA1.5X2								Adhesive	Gray	120 ft
181-00604	SLHD1.5X2BK4	SLHD1.5X2								Non-Adhesive	Black	120 ft
181-00634	SLHDA1.5X2BK4	SLHDA1.5X2								Adhesive	Black	120 ft
1.5" x 3" (38.1 x 76.2) Nominal Duct Size												
184-15304	SLHD1.5X3W4	SLHD1.5X3	1.52" (38.6)	3.06" (77.7)	1.50" (38.1)	.16" (4.1)	.40" (10.2)	2.60" (66.0)	One row of holes on Φ	Non-Adhesive	White	120 ft
184-15301	SLHDA1.5X3W4	SLHDA1.5X3								Adhesive	White	120 ft
184-15302	SLHD1.5X3G4	SLHD1.5X3								Non-Adhesive	Gray	120 ft
181-00636	SLHDA1.5X3G4	SLHDA1.5X3								Adhesive	Gray	120 ft
181-00605	SLHD1.5X3BK4	SLHD1.5X3								Non-Adhesive	Black	120 ft
181-00635	SLHDA1.5X3BK4	SLHDA1.5X3								Adhesive	Black	120 ft
1.5" x 4" (38.1 x 101.6) Nominal Duct Size												
184-15403	SLHD1.5X4W4	SLHD1.5X4	1.50" (38.1)	4.06" (103.1)	1.50" (38.1)	.16" (4.1)	.40" (10.2)	3.60" (91.4)	One row of holes on Φ	Non-Adhesive	White	120 ft
181-00639	SLHDA1.5X4W4	SLHDA1.5X4								Adhesive	White	120 ft
184-15401	SLHD1.5X4G4	SLHD1.5X4								Non-Adhesive	Gray	120 ft
181-00638	SLHDA1.5X4G4	SLHDA1.5X4								Adhesive	Gray	120 ft
181-00606	SLHD1.5X4BK4	SLHD1.5X4								Non-Adhesive	Black	120 ft
181-00620	SLHDA1.5X4BK4	SLHDA1.5X4								Adhesive	Black	120 ft
2" x 1" (50.8 x 25.4) Nominal Duct Size												
184-21003	SLHD2X1W4	SLHD2X1	2.01" (51.1)	1.05" (26.7)	2.00" (50.8)	.16" (4.1)	.40" (10.2)	.75" (19.1)	Three rows of holes .50" (12.7)	Non-Adhesive	White	120 ft
181-00642	SLHDA2X1W4	SLHDA2X1								Adhesive	White	120 ft
184-21002	SLHD2X1G4	SLHD2X1								Non-Adhesive	Gray	120 ft
181-00641	SLHDA2X1G4	SLHDA2X1								Adhesive	Gray	120 ft
181-00607	SLHD2X1BK4	SLHD2X1								Non-Adhesive	Black	120 ft
181-00640	SLHDA2X1BK4	SLHDA2X1								Adhesive	Black	120 ft
2" x 2" (50.8 x 50.8) Nominal Duct Size												
184-22008	SLHD2X2W4	SLHD2X2	2.03" (51.6)	2.06" (52.3)	2.00" (50.8)	.16" (4.1)	.40" (10.2)	1.62" (41.1)	Three rows of holes .50" (12.7)	Non-Adhesive	White	120 ft
184-22003	SLHDA2X2W4	SLHDA2X2								Adhesive	White	120 ft
184-22005	SLHD2X2G4	SLHD2X2								Non-Adhesive	Gray	120 ft
181-00644	SLHDA2X2G4	SLHDA2X2								Adhesive	Gray	120 ft
181-00608	SLHD2X2BK4	SLHD2X2								Non-Adhesive	Black	120 ft
181-00643	SLHDA2X2BK4	SLHDA2X2								Adhesive	Black	120 ft

Dimensions are approximate and subject to technical changes. Use **Part No.** for ordering and **Type** for specification purposes. High density slotted wall duct in larger sizes continued on the next page. Covers are listed on page 117.

High Density Slotted Duct

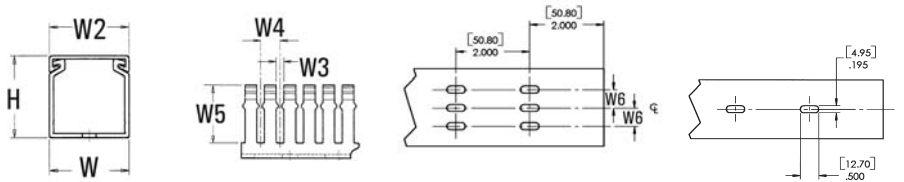

File # E64139 File # 49249

Product Selection													
Article No.	Part No.	Type	Width (W)	Height (H)	Width (W2)	Width (W3)	Width (W4)	Width (W5)	Width (W6)	Description	Color	Pkg. Qty.	
			in. (mm)	in. (mm)	in. (mm)	in. (mm)	in. (mm)	in. (mm)	in. (mm)			in. (mm)	ft. (6 ft. lengths)
2" x 3" (50.8 x 76.2) Nominal Duct Size													
184-23006	SLHD2X3W4	SLHD2X3								Three rows of holes .50" (12.7)	Non-Adhesive	White	120 ft
184-23003	SLHDA2X3W4	SLHDA2X3									Adhesive	White	120 ft
184-23004	SLHD2X3G4	SLHD2X3	2.02"	3.06"	2.00"	.16"	.40"	2.60"			Non-Adhesive	Gray	120 ft
181-00646	SLHDA2X3G4	SLHDA2X3	(51.3)	(77.7)	(50.8)	(4.1)	(10.2)	(66.0)			Adhesive	Gray	120 ft
181-00609	SLHD2X3BK4	SLHD2X3									Non-Adhesive	Black	120 ft
181-00645	SLHDA2X3BK4	SLHDA2X3									Adhesive	Black	120 ft
2" x 4" (50.8 x 101.6) Nominal Duct Size													
184-24007	SLHD2X4W4	SLHD2X4								Three rows of holes .50" (12.7)	Non-Adhesive	White	120 ft
184-24003	SLHDA2X4W4	SLHDA2X4									Adhesive	White	120 ft
184-24004	SLHD2X4G4	SLHD2X4	2.00"	4.06"	2.00"	.16"	.40"	3.60"			Non-Adhesive	Gray	120 ft
181-00648	SLHDA2X4G4	SLHDA2X4	(50.8)	(103.1)	(50.8)	(4.1)	(10.2)	(91.4)			Adhesive	Gray	120 ft
181-00610	SLHD2X4BK4	SLHD2X4									Non-Adhesive	Black	120 ft
181-00647	SLHDA2X4BK4	SLHDA2X4									Adhesive	Black	120 ft
3" x 1" (76.2 x 25.4) Nominal Duct Size													
181-00613	SLHD3X1W4	SLHD3X1								Three rows of holes 1.00" (25.4)	Non-Adhesive	White	120 ft
181-00652	SLHDA3X1W4	SLHDA3X1									Adhesive	White	120 ft
181-00612	SLHD3X1G4	SLHD3X1	3.02"	1.00"	3.00"	.16"	.40"	.75"			Non-Adhesive	Gray	120 ft
181-00651	SLHDA3X1G4	SLHDA3X1	(76.7)	(25.4)	(76.2)	(4.1)	(10.2)	(19.1)			Adhesive	Gray	120 ft
181-00611	SLHD3X1BK4	SLHD3X1									Non-Adhesive	Black	120 ft
181-00649	SLHDA3X1BK4	SLHDA3X1									Adhesive	Black	120 ft
3" x 2" (76.2 x 50.8) Nominal Duct Size													
184-32004	SLHD3X2W4	SLHD3X2								Three rows of holes 1.00" (25.4)	Non-Adhesive	White	120 ft
181-00655	SLHDA3X2W4	SLHDA3X2									Adhesive	White	120 ft
184-32001	SLHD3X2G4	SLHD3X2	3.03"	2.06"	3.00"	.16"	.40"	1.62"			Non-Adhesive	Gray	120 ft
181-00654	SLHDA3X2G4	SLHDA3X2	(77.0)	(52.3)	(76.2)	(4.1)	(10.2)	(41.1)			Adhesive	Gray	120 ft
181-00614	SLHD3X2BK4	SLHD3X2									Non-Adhesive	Black	120 ft
181-00653	SLHDA3X2BK4	SLHDA3X2									Adhesive	Black	120 ft
3" x 3" (76.2 x 76.2) Nominal Duct Size													
184-33004	SLHD3X3W4	SLHD3X3								Three rows of holes 1.00" (25.4)	Non-Adhesive	White	120 ft
184-33001	SLHDA3X3W4	SLHDA3X3									Adhesive	White	120 ft
184-33002	SLHD3X3G4	SLHD3X3	3.02"	3.06"	3.00"	.16"	.40"	2.60"			Non-Adhesive	Gray	120 ft
181-00657	SLHDA3X3G4	SLHDA3X3	(76.7)	(77.7)	(76.2)	(4.1)	(10.2)	(66.0)			Adhesive	Gray	120 ft
181-00615	SLHD3X3BK4	SLHD3X3									Non-Adhesive	Black	120 ft
181-00656	SLHDA3X3BK4	SLHDA3X3									Adhesive	Black	120 ft
3" x 4" (76.2 x 101.6) Nominal Duct Size													
184-34005	SLHD3X4W4	SLHD3X4								Three rows of holes 1.00" (25.4)	Non-Adhesive	White	120 ft
184-34001	SLHDA3X4W4	SLHDA3X4									Adhesive	White	120 ft
184-34003	SLHD3X4G4	SLHD3X4	3.00"	4.06"	3.00"	.16"	.40"	3.60"			Non-Adhesive	Gray	120 ft
181-00659	SLHDA3X4G4	SLHDA3X4	(76.2)	(103.1)	(76.2)	(4.1)	(10.2)	(91.4)			Adhesive	Gray	120 ft
181-00616	SLHD3X4BK4	SLHD3X4									Non-Adhesive	Black	120 ft
181-00658	SLHDA3X4BK4	SLHDA3X4									Adhesive	Black	120 ft

Dimensions are approximate and subject to technical changes. Use **Part No.** for ordering and **Type** for specification purposes. High density slotted wall duct in larger sizes continued on the next page. Covers are listed on page 117.

High Density Slotted Duct

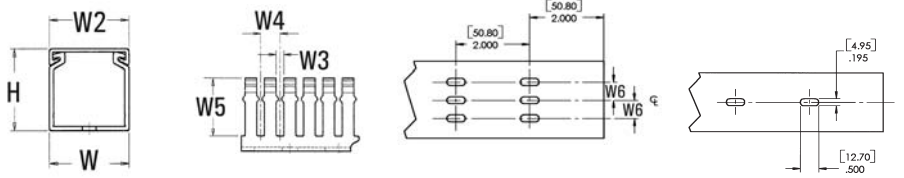

File # E64139 File # 49249

Product Selection												
Article No.	Part No.	Type	Width (W)	Height (H)	Width (W2)	Width (W3)	Width (W4)	Width (W5)	Width (W6)	Description	Color	Pkg. Qty. ft. (6 ft. lengths)
			in. (mm)	in. (mm)	in. (mm)	in. (mm)	in. (mm)	in. (mm)	in. (mm)			
4" x 2" (101.6 x 50.8) Nominal Duct Size												
184-42003	SLHD4X2W4	SLHD4X2	4.03" (102.4)	2.06" (52.3)	4.00" (101.6)	.16" (4.1)	.40" (10.2)	1.62" (41.1)	Three rows of holes 1.50" (38.1)	Non-Adhesive	White	120 ft
181-00665	SLHDA4X2W4	SLHDA4X2								Adhesive	White	120 ft
184-42001	SLHD4X2G4	SLHD4X2								Non-Adhesive	Gray	120 ft
181-00664	SLHDA4X2G4	SLHDA4X2								Adhesive	Gray	120 ft
181-00617	SLHD4X2BK4	SLHD4X2								Non-Adhesive	Black	120 ft
181-00663	SLHDA4X2BK4	SLHDA4X2								Adhesive	Black	120 ft
4" x 3" (101.6 x 76.2) Nominal Duct Size												
184-43003	SLHD4X3W4	SLHD4X3	4.03" (102.4)	3.06" (77.7)	4.00" (101.6)	.16" (4.1)	.40" (10.2)	2.60" (66.0)	Three rows of holes 1.50" (38.1)	Non-Adhesive	White	120 ft
181-00152	SLHDA4X3W4	SLHDA4X3								Adhesive	White	120 ft
184-43001	SLHD4X3G4	SLHD4X3								Non-Adhesive	Gray	120 ft
181-00153	SLHDA4X3G4	SLHDA4X3								Adhesive	Gray	120 ft
181-00618	SLHD4X3BK4	SLHD4X3								Non-Adhesive	Black	120 ft
181-00154	SLHDA4X3BK4	SLHDA4X3								Adhesive	Black	120 ft
4" x 4" (101.6 x 101.6) Nominal Duct Size												
184-44004	SLHD4X4W4	SLHD4X4	4.00" (101.6)	4.06" (103.1)	4.00" (101.6)	.16" (4.1)	.40" (10.2)	3.60" (91.4)	Three rows of holes 1.50" (38.1)	Non-Adhesive	White	120 ft
184-44001	SLHDA4X4W4	SLHDA4X4								Adhesive	White	120 ft
184-44002	SLHD4X4G4	SLHD4X4								Non-Adhesive	Gray	120 ft
181-00667	SLHDA4X4G4	SLHDA4X4								Adhesive	Gray	120 ft
181-00619	SLHD4X4BK4	SLHD4X4								Non-Adhesive	Black	120 ft
181-00666	SLHDA4X4BK4	SLHDA4X4								Adhesive	Black	120 ft

Dimensions are approximate and subject to technical changes. Use **Part No.** for ordering and **Type** for specification purposes. Covers are listed on page 117.

Covers

Covers for Pro-Duct wiring duct are sold separately. The covers are interchangeable among the 3 styles of duct (solid, slotted and high density).

For modular packaging, remove the last digit "4" from the HellermannTyton part number. e.g., TC1G = 1" wide cover/gray/modular packaging.



File # E64139 File # 49249

Product Selection						
Article No.	Part No.	Type	Width (W)		Color	Pkg. Qty.
			in.	(mm)		ft. (6 ft. lengths)
.5" wide covers						
181-00443	TC.5W4	TC.5	.76"	(19.30)	White	120 ft
181-00442	TC.5G4	TC.5	.76"	(19.30)	Gray	120 ft
181-90050	TC.5BK4	TC.5	.76"	(19.30)	Black	120 ft
.75" wide covers						
181-00447	TC.75W4	TC.75	1.01"	(25.65)	White	120 ft
181-00446	TC.75G4	TC.75	1.01"	(25.65)	Gray	120 ft
181-00445	TC.75BK4	TC.75	1.01"	(25.65)	Black	120 ft
1" wide covers						
181-91008	TC1W4	TC1	1.00"	(25.40)	White	120 ft
181-91004	TC1G4	TC1	1.00"	(25.40)	Gray	120 ft
181-91000	TC1BK4	TC1	1.00"	(25.40)	Black	120 ft
1.5" wide covers						
181-91510	TC1.5W4	TC1.5	1.50"	(38.10)	White	120 ft
181-91507	TC1.5G4	TC1.5	1.50"	(38.10)	Gray	120 ft
181-91503	TC1.5BK4	TC1.5	1.50"	(38.10)	Black	120 ft
2" wide covers						
181-92011	TC2W4	TC2	2.00"	(50.80)	White	120 ft
181-92005	TC2G4	TC2	2.00"	(50.80)	Gray	120 ft
181-92001	TC2BK4	TC2	2.00"	(50.80)	Black	120 ft
3" wide covers						
181-93011	TC3W4	TC3	3.00"	(76.20)	White	120 ft
181-93008	TC3G4	TC3	3.00"	(76.20)	Gray	120 ft
181-93003	TC3BK4	TC3	3.00"	(76.20)	Black	120 ft
4" wide covers						
181-94014	TC4W4	TC4	4.00"	(101.60)	White	120 ft
181-94009	TC4G4	TC4	4.00"	(101.60)	Gray	120 ft
181-94003	TC4BK4	TC4	4.00"	(101.60)	Black	120 ft
6" wide covers						
181-96002	TC6W4	TC6	6.00"	(152.40)	White	60 ft
181-96000	TC6G4	TC6	6.00"	(152.40)	Gray	60 ft
181-00448	TC6BK4	TC6	6.00"	(152.40)	Black	60 ft
8" wide covers						
181-00451	TC8W4	TC8	8.00"	(203.20)	White	60 ft
181-00450	TC8G4	TC8	8.00"	(203.20)	Gray	60 ft
181-00449	TC8BK4	TC8	8.00"	(203.20)	Black	60 ft

Dimensions are approximate and subject to technical changes. Use **Part No.** for ordering and **Type** for specification purposes.

Wiring Duct

Intrinsic Blue Wiring Duct

Designed for identification purposes, HellermannTyton offers intrinsic blue Pro-Duct wiring duct. Manufactured from the same PVC material as HellermannTyton's standard duct, the blue color indicates that the wiring contained in the duct runs to intrinsically safe components in the control panel. Control panels used in chemical plants, grain elevators or other environments where explosive gases may exist are examples of where intrinsic blue duct might be needed.

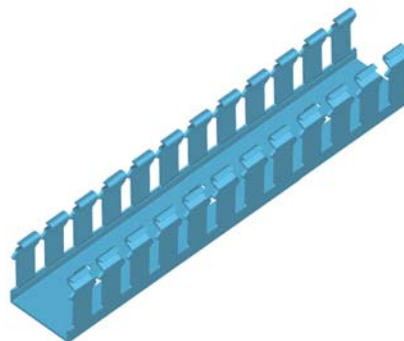

Product Selection		Type	Width (W)		Height (H)		Color	Pkg. Qty.
Article No.	Part No.		in. (mm)	in. (mm)	in. (mm)	in. (mm)		ft. (6 ft. lengths)
Intrinsic Blue Slotted Wall Duct								
181-11010	SL1X1BLU4	SL1x1	1.00" (25.40)	1.05" (26.7)	Blue	120 ft		
181-12003	SL1X2BLU4	SL1X2	1.03" (26.16)	2.06" (52.32)	Blue	120 ft		
181-13004	SL1X3BLU4	SL1X3	1.02" (25.91)	3.06" (77.72)	Blue	120 ft		
181-15506	SL1.5X1.5BLU4	SL1.5X1.5	1.52" (38.61)	1.56" (34.6)	Blue	120 ft		
181-00160	SL1.5X1BLU4	SL1.5X1	1.50" (38.10)	1.05" (26.67)	Blue	120 ft		
181-22021	SL2X2BLU4	SL2x2	2.03" (51.56)	2.00" (50.80)	Blue	120 ft		
181-23004	SL2X3BLU4	SL2X3	2.02" (51.31)	3.00" (76.20)	Blue	120 ft		
181-33012	SL3X3BLU4	SL3X3	3.02" (76.71)	3.00" (76.20)	Blue	120 ft		
181-44024	SL4X4BLU4	SL4X4	4.00" (101.60)	4.00" (101.60)	Blue	120 ft		
Intrinsic Blue Duct - Covers								
181-91002	TC1BLU4	TC1	1.00" (25.40)	n/a n/a	Blue	120 ft		
181-91505	TC1.5BLU4	TC1.5	1.50" (38.10)	n/a n/a	Blue	120 ft		
181-92003	TC2BLU4	TC2	2.00" (50.80)	n/a n/a	Blue	120 ft		
181-93005	TC3BLU4	TC3	3.00" (76.20)	n/a n/a	Blue	120 ft		
181-94007	TC4BLU4	TC4	4.00" (101.60)	n/a n/a	Blue	120 ft		

Dimensions are approximate and subject to technical changes. Use **Part No.** for ordering and **Type** for specification purposes.

Duct Notching Tool

HellermannTyton's duct notching tool is designed for use with HellermannTyton's slotted wall and slotted high density Pro-Duct wiring duct. This hand held tool features plastic grips for easy handling and allows users to notch a duct sidewall section down to the very base for finger and sidewall removal.



Product Selection		Type	Description	Pkg. Qty.
Article No.	Part No.			
182-00002	TDNT	TDNT	Notching tool	1

Dimensions are approximate and subject to technical changes. Use **Part No.** for ordering and **Type** for specification purposes.

Solid Style Wire Retainers

The solid wall wire retainer is inserted in the duct and snaps into place. The retainer can be used on any smooth, straight run of duct and can work with vertical and overhead applications. Solid wall wire retainers are manufactured from black PVC.

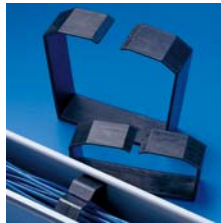

Slotted Style Wire Retainers

The slotted wall wire retainer snaps in from the outside of the duct, allowing for fast and easy installation and removal. The retainer spans approximately 90% over the duct opening for effective wire management. Slotted wall wire retainers are manufactured from black nylon 6/6.



Product Selection						
Article No.	Part No.	Type	Description	Color	Pkg. Qty.	
Solid Style Wire Retainers						
181-20201	SDWR2X20K2	SDWR2X20	Wire Retainer for 2" X 2" Solid Duct	Black	50	
181-00158	SDWR4X20K2	SDWR4X20	Wire Retainer for 4" X 2" Solid Duct	Black	50	
181-00441	SDWR4X40P2	SDWR4X40	Wire Retainer for 4" X 4" Solid Duct	Black	10	
Slotted Style Wire Retainers						
181-20021	SLWR20C2	SLWR20	Wire Retainer for 2" Wide Slotted Duct	Black	100	
181-30031	SLWR30C2	SLWR30	Wire Retainer for 3" Wide Slotted Duct	Black	100	
181-40041	SLWR40C2	SLWR40	Wire Retainer for 4" Wide Slotted Duct	Black	100	

Dimensions are approximate and subject to technical changes. Use **Part No.** for ordering and **Type** for specification purposes.

Wiring Duct Accessories

Panel Mounting Rivets and Tool

HellermannTyton panel rivets are one piece drive rivets that provide a fast, economical means of affixing wiring duct. The rivet is inserted into a 3/16" pre-punched hole and the pin is driven into the base, thereby expanding the rivet legs and locking the duct and sub-panel in place. The panel thickness (including the duct thickness) should be a maximum of 3/16". A panel rivet tool is also available for quick and easy installation of the drive rivets.



Straight Connectors

HellermannTyton's PVC straight connectors join straight duct runs to cover and protect wires. The connectors can be used with all sizes of duct. Supplied in six foot lengths, they can be cut to fit duct sidewall heights.

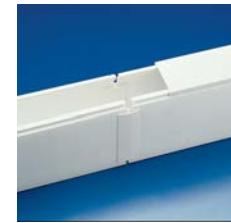

Corner Strips

HellermannTyton corner strips are supplied in six foot lengths which can be cut to provide a rounded corner for two duct sections meeting at right angles. They are made from PVC material and can be used with any size HellermannTyton wiring duct.



Product Selection						
Article No.	Part No.	Type	Description	Color	Pkg. Qty.	
181-00139	PR1	PR11	Panel Rivet	Natural	1000	
182-00001	PRT1	PRT1	Panel Rivet Tool	Yellow	1	
181-00003	SCG	SCG	Straight Connector - gray	Gray	6ft	
181-00004	SCW	SCW	Straight Connector - white	White	6ft	
181-00001	CSG	CSG	Corner Strip - gray	Gray	6ft	
181-00002	CSW	CSW	Corner Strip - white	White	6ft	

Dimensions are approximate and subject to technical changes. Use **Part No.** for ordering and **Type** for specification purposes.

Wiring Duct

Wiring Duct Material Properties



Physical Properties	Material	ASTM Method	Test Units	Test Results
Specific Gravity (Gray)	PVC	D-792	—	1.4
Durometer Hardness	PVC	D-2240	Shore Hardness	80D
Flexural Strength	PVC	D-790	psi	12,000
Modulus of Elasticity (Tension)	PVC	D-638	psi	360,000
Dielectric Constant- 60 cps @ 30°C 60H	PVC	D-150	—	3.9
Dielectric Constant-1,000 cps @ 30° C 10°H	PVC	D-150	—	3.3
Coefficient of Thermal Conductivity	PVC	D-177	btu/in.hr.FT ² /°F	1.3
Coefficient of Linear Expansion	PVC	D-696	in./in./OF	4.0 x 10 ⁻⁵
Heat Deflection Temperature (264 psi)	PVC	D-648	°F	155
Tensile Strength (+73°F)	PVC	D-638	psi	6,600
Izod Impact Strength (+73°F)	PVC	D-256	ft. lbs./in. notch	15
Flame Resistance	PVC	D-635	—	Self-extinguishing
UL Standard 94	PVC		.029 and .062	94V-O

Wiring Capacity

Duct Size (WxH)	Duct Area (Sq. In.)	12 AWG	14 AWG	14 AWG	16 AWG	18 AWG	22 AWG
		Wire O.D.					
		0.158	0.165	0.139	0.125	0.113	0.065
.5x.5	0.18	5	4	6	7	9	27
.5x1	0.38	10	9	13	15	19	57
.75x.75	0.28	7	7	9	11	14	42
1x1	0.731	19	17	24	30	36	110
1x1.5	1.15	29	27	38	47	57	173
1x2	1.564	40	37	52	64	78	236
1x3	2.31	59	54	76	94	115	348
1x4	2.98	76	70	98	121	149	449
1.5x1	1.196	30	28	39	49	60	180
1.5x1.5	1.864	48	44	61	76	93	281
1.5x2	2.527	64	59	83	103	126	381
1.5x3	3.761	96	88	124	153	188	567
1.5x4	4.92	125	115	162	200	245	741
2x1	1.665	42	39	55	68	83	251
2x2	3.482	89	81	115	142	174	525
2x3	5.213	133	122	172	212	260	785
2x4	6.874	175	161	226	280	343	1036
3x1	2.584	66	60	85	105	129	389
3x2	5.4	138	126	178	220	269	814
3x3	8.12	207	190	267	331	405	1223
3x4	10.77	275	252	355	439	537	1623
3x5	13.44	343	314	443	548	670	2025
4x2	7.32	187	171	241	298	365	1103
4x3	11	281	257	363	448	549	1658
4x4	14.66	374	343	483	597	731	2209
4x5	18.32	467	428	604	747	913	2761
6x4	22.32	569	522	735	909	1113	3363
8x4	30.01	765	702	989	1223	1496	4522

Formula used to calculate fill capacity: Number of wires = duct area / (1.57 x (wire o.d.)²) or duct area x (0.637/(wire o.d.)²) * 50% Fill Capacity